

**Check
Me
Out!**



Want a quick review? Check out this week's (or previous week's) tutorials at mcdbsesmath.weebly.com/homework.html

This week: comparing and ordering decimals

Write the Correct Comparison Symbol ($>$, $<$ or $=$) in Each Box

1) 5.08 0.508

11) 6.24 6.25

2) 6.21 0.621

12) 5.35 0.535

3) 4.64 4.6

13) 9.9 9.95

Order the decimals as described.

Greatest to Least

0.8, 0.75, 0.16, 0.4

_____ > _____ > _____ > _____

Answer the question about the figure or set of figures. NOTE: each measurement is a whole number.

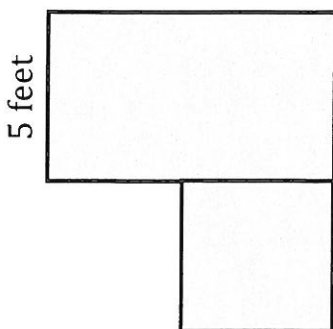

The rectangle's width is 5 feet and its perimeter is 30 feet. The length of the rectangle is half the length of the square. What is the area of the square? _____

Write each multiplication expression as an equivalent repeated addition expression.

$$(5) 7 \times \frac{5}{8} =$$

$$(7) \frac{3}{5} \times 3 =$$

$$(9) \frac{2}{3} \times 3 =$$

$$(11) \frac{3}{10} \times 4 =$$

Identify each fraction as 'less', 'equal', or 'greater' when compared to $\frac{1}{2}$.

$$9) \frac{1}{8}$$

$$10) \frac{2}{5}$$

$$11) \frac{10}{12}$$

$$12) \frac{5}{10}$$

$$13) \frac{3}{4}$$

$$14) \frac{1}{3}$$

- | | |
|-----|-------------|
| 9. | <u>less</u> |
| 10. | _____ |
| 11. | _____ |
| 12. | _____ |
| 13. | _____ |
| 14. | _____ |

Round each decimal to the nearest whole and the nearest tenth.

4.380 $\left\{ \begin{array}{l} \text{nearest whole: } \underline{\hspace{2cm}} \\ \text{nearest tenth: } \underline{\hspace{2cm}} \end{array} \right.$

2.974 $\left\{ \begin{array}{l} \text{nearest whole: } \underline{\hspace{2cm}} \\ \text{nearest tenth: } \underline{\hspace{2cm}} \end{array} \right.$